



FOR SAME DAY SHIPMENT CALL BY 3PM EST

1-800-852-7874
386-677-4804

www.airbrushstore.com
info@airbrushstore.com

ORDERING INFORMATION

ABOUT US:

We pride ourselves on providing quality products at reasonable prices with courteous service and knowledgeable advice. We have been in business since 1981. Many of our customers are veteran airbrush artists who rely on our quick service.

Orders of in stock items, placed by 3 p.m. EST, will be shipped the same day. 99% of the items in our catalog are kept in stock at all times unless otherwise noted.

PAYMENT:

We accept payment by MasterCard, Visa, Discover, American Express, Money Order or Certified Check. With prior approval, we will accept company checks - 3 trade references are required.

SHIPPING & DELIVERY:

Orders are generally shipped by U.P.S. Most orders are shipped same day. Occasionally, but not often, there is a back-order. We will let you know which items will be delayed and when to expect them. U.P.S. Ground Service is cost effective and most customers receive 1 to 4 day service. Plan your orders accordingly. If you need an order fast - 1, 2, and 3 day air service is available. **Florida orders receive Next Day Service.**

Please call before 3 P.M. EST for same day shipment.

SCHOOLS:

Please contact us with your needs. Our knowledgeable staff will assist you in choosing the right equipment and supplies at attractive prices.

PRICES:

Catalog prices are current as of the date on the front cover. However, **prices are subject to change without notice.** We will notify you at the time of your order if there has been a price change.

PRICE MATCHING:

Although we price our items aggressively, you may, on occasion, find a lower price somewhere else. If you prefer to order from us - give us a call - we'll try to match the lower price - or beat it - if we can. Our only requirement is that our competitor must have the item in stock, ready to ship.

RETURN POLICY:

Our return policy is simple - our goal is your satisfaction. **Defective items** will be replaced or repaired - we'll pay shipping both ways. **Unwanted items** must be in new and saleable condition, with all original packing. You pay return shipping. We'll refund the purchase price but not shipping costs.

As each situation is unique, please call us before returning anything.

the airbrush store
1-800-852-7874
www.airbrushstore.com

the airbrush store

1-800-852-7874

www.airbrushstore.com

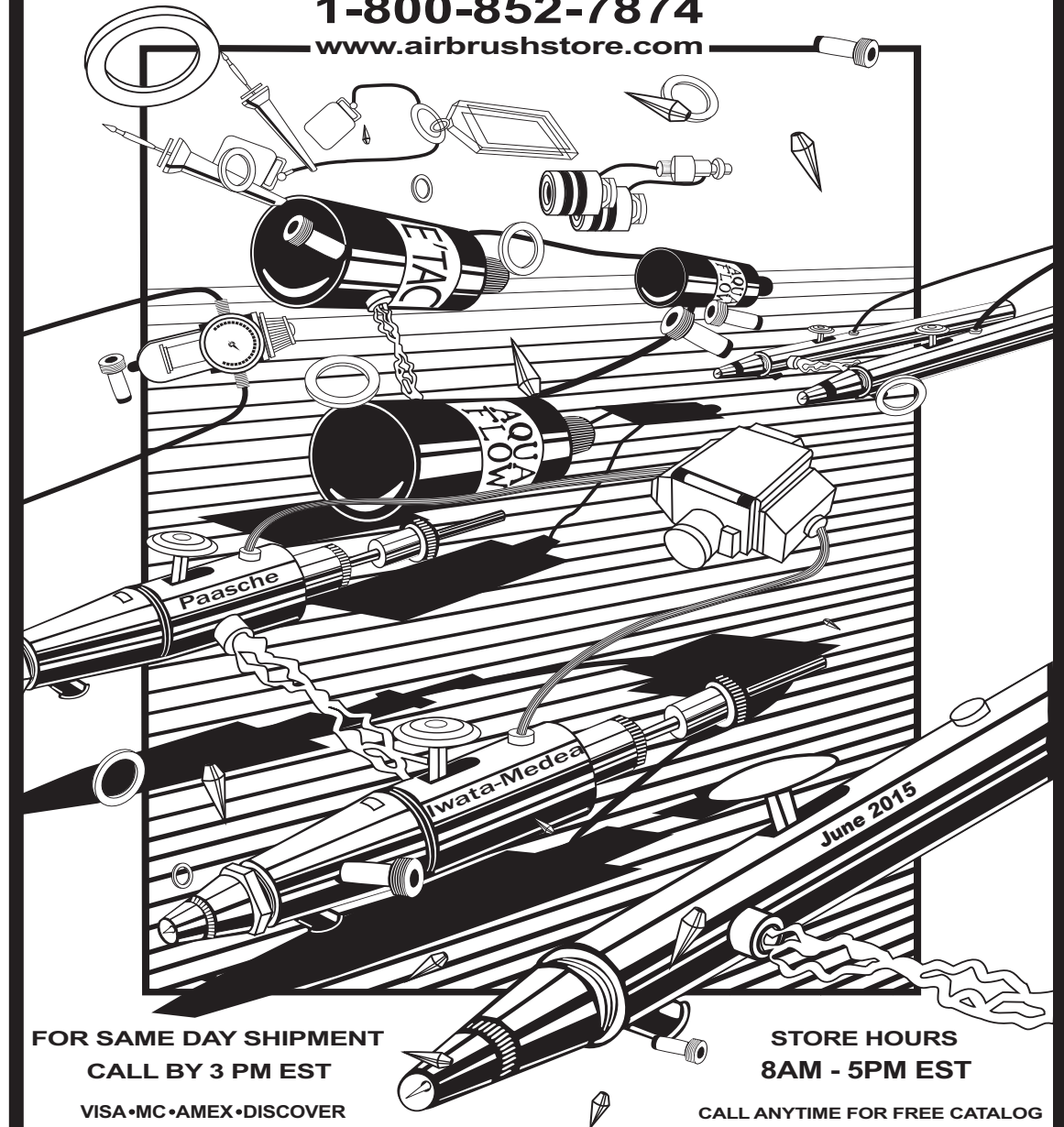

FOR SAME DAY SHIPMENT
CALL BY 3 PM EST

VISA • MC • AMEX • DISCOVER

STORE HOURS
8AM - 5PM EST

CALL ANYTIME FOR FREE CATALOG

E'TAC



AQUA FLOW



E'TAC Colors

Private Stock Series Premium

ET-112.....	Blue Thunder
FL-300.....	Fluorescent Pink
FL-301.....	Fluorescent Orange
FL-302.....	Fluorescent Yellow
FL-303.....	Fluorescent Green
FL-304.....	Fluorescent Magenta
FL-305.....	Fluorescent Blue
FL-306.....	Fluorescent Purple
OP-200.....	Opaque HS Carbon Black
OP-201.....	Opaque Titanium Plasma White
OP-202.....	Opaque Light Flesh Tone
OP-204.....	Opaque Light Pink
OP-205.....	Opaque Lightly Yellow
SO-151.....	Semi-Opaque Magneta
SO-152.....	Semi-Opaque Violet
SO-153.....	Semi-Opaque Yellow
SO-154.....	Semi-Opaque Green
TR-101.....	Shading Black
TR-102.....	Arylide Yellow
TR-103.....	Golden Ocher
TR-104.....	Azo Orange
TR-105.....	Naphthoal Red
TR-107.....	Pyrrrole Red
TR-108.....	Quinacridone Magenta
TR-111.....	Phthalocyanine Green
TR-112.....	Phthalocyanine Turquoise
TR-113.....	Brick Red Ocher
TR-114.....	Brown Ocher
TR-115.....	Burnt Umber
TR-116.....	Blue Violet
TR-117.....	Red Shade Violet
TR-118.....	Culebra Gold
TR-119.....	Vieques Blue
TR-120.....	Agua Rica
TR-121.....	Rain Forest Green
TR-122.....	Sepia Smoke
TR-124.....	Ultra-Marine Blue
TR-126.....	Payne's Gray

TR = Transparent Color OP = Opaque Color SO = Semi-Opaque FL = Fluorescent

Size	All Colors
4 oz.	\$8.95
8 oz.	\$12.95
16 oz.	\$18.95
32 oz.	\$29.95

4 oz. 8 oz. 16 oz. 32 oz.

Extend-Air:	EX-450	8.95	12.95	17.95	27.95
Reduce Air:	FX-500	12.95	24.95	36.95	
Pol'e Tac Top Binder:	TB-451	8.95	12.95	17.95	27.95

AQUA FLOW Colors

T-101.....	Golden Yellow	TU-118.....	Ultra Black
T-102.....	Yellow Bright	O-102.....	Opaque Yellow
T-103.....	Orange Bright	O-103.....	Opaque Orange
T-104.....	Burnt Orange	O-107.....	Opaque Red
T-105.....	Pink Rose	O-110.....	Opaque Lavender
T-106.....	Fuschia	O-111.....	Opaque Blue
T-107.....	Red Pure	O-117.....	Opaque Grey
T-108.....	Red Rubine	O-118.....	Opaque Black
T-109.....	Wine	O-151.....	Opaque Sky Blue
T-110.....	Violet	O-155.....	Opaque Aqua
T-111.....	Blue Pure	O-204.....	Opaque Pink
T-112.....	Royal Blue	O-206.....	Opaque Peach
T-113.....	Navy Blue	O-500.....	Opag. Fleshtone
T-114.....	Brown Red	O-900.....	Opaque White
T-115.....	Dark Brown	P-100.....	Pearl Silver
T-116.....	Green Forest	P-200.....	Pearl Royal Gold
T-117.....	Grey Trans.	P-300.....	Pearl Royal Copper
T-118.....	Jet Black	P-400.....	Pearl Royal Sparkle
T-119.....	Gold Trans.	B-201.....	Hot Yellow
T-120.....	Popsicle Blue	B-202.....	Hot Red
T-121.....	Turquoise	B-203.....	Hot Blue
T-122.....	Popsicle Violet	B-204.....	Hot Pink
T-151.....	Trans. Sky Blue	B-205.....	Hot Green
T-153.....	Hawaiian Green	B-206.....	Hot Orange
T-160.....	Watermelon	B-207.....	Hot Red Violet
T-171.....	Bahama Blue	B-208.....	Hot Purple
T-180.....	Magenta (Process)	B-209.....	Hot Aqua
T-900.....	Trans. White	B-217.....	Hot Rocket Red
TS-118.....	Silk Black		

T = Transparent Color O = Opaque Color B = Hot Color

Size	All Colors	Pearls
4 oz.	\$8.99	\$10.99
8 oz.	\$11.99	\$14.99
16 oz.	\$17.99	\$21.99
32 oz.	\$28.79	\$34.99

		4 oz.	8 oz.	16 oz.	32 oz.
Retarder:	R-100	5.99	8.99	14.99	17.99
Top Binder:	T-100	5.99	8.99	14.99	17.99
Tip Flow:	TF-100	8.99	11.99	17.99	28.79
Medea AB Cleaner:	6 500 32	3.29	4.69	5.99	8.49

INTRODUCTORY SETS

Aqua Flow 2 oz. Color Sets
Our Price \$19.95

- AF SET 1** - Primary Colors: Black, White, Red, Yellow, Blue.
AF SET 2 - Secondary Colors: Green, Orange, Violet, Brown, Turquoise.
AF SET 3 - Hot Colors: Pink, Green, Yellow, Blue, Violet.

WORKING WITH:

LEATHER

First prep the leather by cleaning with acetone and a clean cloth. This takes off dirt, oil and waxes so that the paint will adhere. Sketch the design out with white or lay down a light base coat of white and proceed as normal. It is sometimes necessary to use several light coats rather than one heavy coat to bring color out. Use a compact hair dryer to speed drying and to cure the paint. When the artwork is dry, rub with mink oil or good quality leather treatment.

DENIM

Light denim will work much the same as a T-shirt. Dark denim should be pre-washed to remove sizing from material. Sizing will prevent colors from adhering to the material. Sketch out your design with white. Some artists prefer to lay down a base coat of white and then work the design like a T-shirt. Because denim is so thick, multiple coats of color are necessary. A compact hair dryer speeds up the process of painting multiple coats. NOW, for extra wash fastness, top coat your artwork with top binder and heat set.

AUTO TAGS

Scuff the tag lightly with 600 grit sandpaper or a fine scotch bright pad. Next, lay down a light coat of white, light blue or gray, depending on the design you are painting. This helps the colors that follow to cover more evenly and dry faster. A compact hair dryer to dry the paint as you go along greatly increases productivity. Now, dry the artwork and top coat with a quality "high gloss" clear acrylic enamel. When painting tags, use retarder very sparingly in your colors. Too much will result in fish eyes (round spots where the color does not cover).

Did you know E'TAC Extend - Air is a beefed up version of E'TAC Private Stock base? It contains additional cross-linking materials as well as all the enhancements found in E'TAC Multi-Substrate line of colors meaning you can reduce it with water to a water-color consistency.

Can be used alone as a Top Binder, prior to working on dark garments, to seal the fabric. Use, as well, over completed fabric art to add additional protection and finish.

Heat set after drying @ 340 degrees F for 16 seconds. Iron hot as possible without scorching if no heat press is available. Turn inside out or use wax paper to reduce drag.

AIRLINE ACCESSORIES

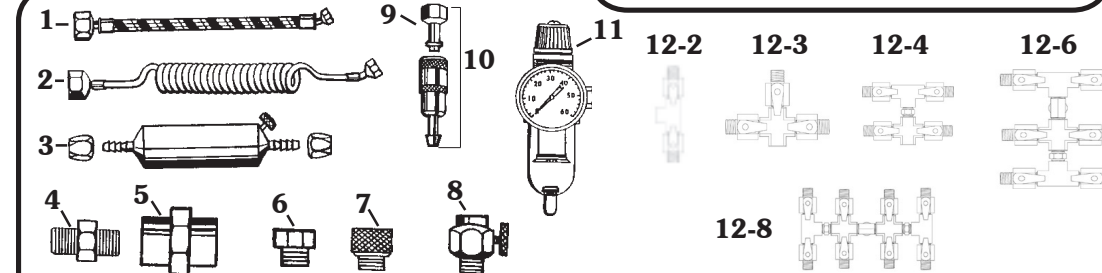

1.	A-1/8"-6'	Airhose w/ cplgs.	8.40
	A-1/8"-8'	Airhose w/ cplgs.	10.36
	A-1/8"-10'	Airhose w/ cplgs.	12.20
	A-1/8"-15'	Airhose w/ cplgs.	15.96
2.	CH-10'	Coiled Air Hose	14.25
3.	MT	Moisture Trap	13.20
4.	HF-33	1/4" Coupler/Male	1.64
5.	UM-13	1/4" Coupler/Female ...	3.20
6.	A-151	Badger to Paasche Airhose .	4.20
7.	A-188	Iwata to Paasche Airhose ...	4.20
8.	3A	Needle valve controis air volume to the Airbrush	8.80
9.	A-192	Mini Disconnect Plug ...	3.00
10.	A-191	Mini Quick Disconnect ...	12.40
11.	AR-75	Regulator w/Filter & Gauge ..	28.00
12.	HFM Series	Manifolds feature individual open-close valves for each airbrush and easy expandability by adding extra units.	
	12-2HFM-2-1/4	2 Unit Manifold	14.36
	12-3HFM-3-1/4	3 Unit Manifold	19.80
	12-4HFM-4-1/4	4 Unit Manifold	28.80
	12-6HFM-6-1/4	6 Unit Manifold	47.20
	12-8HFM-8-1/4	8 Unit Manifold	61.60

**Efficient!
Quick
Disconnect!**

One HOSE!

**4 DIFFERENT
AIRBRUSHES**

(Quick Disconnects sold separately)

BADGER 8 FT. QD HOSE. Only **27.90**
ITEM 50-2018 (List 37.20)

Q: What is meant by dual-action and single-action?

A: These are two different types of airbrush triggers. Single-action airbrushes are activated by simply depressing the trigger; a preset amount of paint is automatically sprayed. To change the amount of spray, you must stop airbrushing and reset the needle adjustment screw. These are recommended for students because they are less expensive than dual-action. With the more sophisticated dual-action airbrushes, when the user depresses the trigger, only air is released; the second action of drawing back on the trigger releases the paint. This dual-action—down, then back—enables the user to adjust the volume of spray simply by manipulating the trigger and without stopping.

THIS AIR HOSE WORKS WITH ALL MAJOR BRANDS OF AIRBRUSHES.

BE SURE TO ORDER THE CORRECT ADAPTER FOR YOUR AIRBRUSH.

ADAPTER QD PLUGS

PAASCHE (A-192)	3.00
IWATA (51-040)	8.64
THAYER CHANDLER VEGA (51-038)	8.64
BADGER CRESCENDO & ANTHEM (51-038)	8.64

GREAT AIRBRUSH DEALS

THAYER & CHANDLER

- VEGA 2000 Medium 101.⁹⁰
- VEGA 2000 Complete w/ hose 140.⁰⁰
- VEGA NAIL AIRE 126.⁶⁰
- OMNI 3000 121.⁵⁰

List	Our Price
101. ⁹⁰	62.⁷¹
140. ⁰⁰	86.¹⁵
126. ⁶⁰	77.⁹¹
121. ⁵⁰	74.⁷⁷

BADGER

- 175-5 (CRESCENDO) 113.⁰⁰
- 175-7 (CRESCENDO SET) 161.⁰⁰
- 155-2 (ANTHEM) 111.⁰⁰
- 155-7 (ANTHEM SET) 152.⁰⁰

List	Our Price
113. ⁰⁰	78.²³
161. ⁰⁰	111.⁴⁶
111. ⁰⁰	76.⁹⁵
152. ⁰⁰	105.²³

IWATA

- * • CM-B2 (ICM 2002) 548.⁹⁴
- * • CM-SB (ICM 3002) 548.⁹⁴
- * • CM-C2 (ICM 4002) 548.⁹⁴
- * • HP-B PLUS (H-2001) 248.¹⁸
- * • HP-SB PLUS (H-3001) 308.⁹⁵
- * • HP-C PLUS (H-4001) 248.¹⁸

List	Our Price
548. ⁹⁴	451.⁹⁸
548. ⁹⁴	451.⁹⁸
548. ⁹⁴	451.⁹⁸
248. ¹⁸	204.⁹¹
308. ⁹⁵	255.⁰³
248. ¹⁸	204.⁹⁸

IWATA (CONT.)

- HP-BCS (ECL 2000) 129.⁷³
- HP-BCS SET (ECL 2001) 145.¹⁸
- HP-B5 (ECL 2500) 174.⁰²
- HP-SBS (ECL 3500) 174.⁰²
- HP-CS (ECL 4500) 174.⁰²
- * • R-2000 (REVOLUTION BCR) 111.²⁰
- * • R-4500 (REVOLUTION CR) 111.²⁰

List	Our Price
129. ⁷³	107.⁰¹
145. ¹⁸	120.⁴⁴
174. ⁰²	143.⁹⁵
174. ⁰²	143.⁹⁵
174. ⁰²	143.⁹⁵
111. ²⁰	90.⁵¹
111. ²⁰	90.⁵¹

PAASCHE

- VL #3L 86.⁰⁰
- VL SET 124.⁰⁰
- VLST PRO #3L 97.⁵⁰
- MIL #3L (MILLENIUM) 80.⁵⁰
- MIL-SET (MILLENIUM) 101.⁰⁰
- * • AUTF-2 119.⁰⁰

List	Our Price
86. ⁰⁰	49.¹⁴
124. ⁰⁰	70.⁸⁶
97. ⁵⁰	55.⁷¹
80. ⁵⁰	46.⁰⁰
101. ⁰⁰	57.⁷¹
119. ⁰⁰	68.⁰⁰

All models of T&C, Badger, Iwata and Paasche Airbrushes are available at similar discounts to those shown above.

*Special Order Items. Allow 10 - 14 days for delivery.



**VL #3L
49.14**

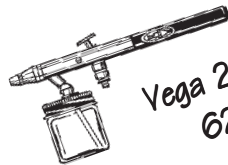

**Vega 2000
62.71**

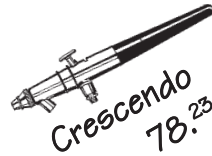

**Crescendo
78.23**



**Eclipse
107.01**

Today, airbrushes are used in a multitude of applications. Artists who use the airbrush will generally have several different types (external or internal mix) as well as styles (gravity- or siphon-feed) on hand for a variety of uses. When selecting an airbrush, consider the type of effect desired (coarse or soft spray), size of area to be painted and type of material to be sprayed.

the airbrush store
1-800-852-7874
www.airbrushstore.com

IWATA BOTTLES

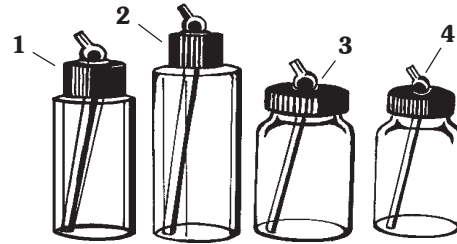

1. I 450-2 Clear PVC 2 oz. bottle (for water-based paints)
2. I 450-4 Clear PVC 4 oz. bottle (for water-based paints)
3. I 480-3 High strength translucent HDPE 3 oz. jar
4. I 480-4 High strength translucent HDPE 4 oz. jar

LIST PRICE \$6.85 EA **OUR PRICE.....\$4.57 EA**

FOR BEST PRICE - BUY IN QUANTITY

QTY 6-11.....\$4.73 QTY 12-23.....\$4.48 QTY 24 & UP.....\$4.23

Iwata bottles will fit most Paasche, Badger and Thayer & Chandler Airbrushes

FAST BLAST

Bottle Assemblies



FB24-2oz FB24-4oz



FB38-3oz FB38-4oz

Easy to Clean, New 4 oz.

Easy to clean color bottles with no-rust black nylon tops. PVC bottles are clear and great for water based paint. HDPE (High density polyethylene) bottles are translucent and can be used for water based paint or solvent based paints - even laquers. LIST PRICE \$6.85 EA **OUR PRICE.....\$4.57EA**

FOR BEST PRICE - BUY IN QUANTITY

QTY 6-11.....\$4.73 QTY 12-23.....\$4.48 QTY 24 & UP.....\$4.23

FAST BLAST CAPS ONLY: \$3.52 EA

PAASCHE BOTTLES

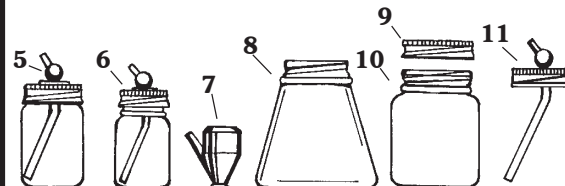
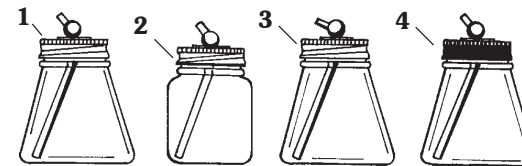

		Retail	Our Price
1. VL-3 oz.	Glass Bottle Assembly	6.60	5.28
2. VLP-3 oz.	Plastic Bottle HDPE Assembly	6.15	4.92
3. H-3 oz.	Glass Bottle Assembly	6.60	5.28
4. PCVL-3 oz.	Glass Bottle Assem. w/ Nylon Cover	8.50	6.80
5. VL- 1 oz.	Glass Bottle Assembly	6.50	5.20
6. VL-1/2 oz.	Glass Bottle Assembly	6.50	5.20
7. VL-1/4 oz.	Metal Color Cup	5.95	4.76
8. H-108 3 oz.	Glass Bottle	1.75	1.40
9. H-190 3 oz.	Plain Cover	.85	.68
10. 62-17P 3 oz.	Plastic HDPE Bottle	1.75	1.40
11. VL3 3 oz.	Cover Assembly	4.95	3.96

- BEST BUYS -

VL-3 oz. in lots of 6	\$5.02 ea.
VL-3 oz. in lots of 12	\$4.75 ea.
VL-3 oz. in lots of 24	\$4.49 ea.
VLP 3 oz. in lots of 6	\$4.67 ea.
VLP 3 oz. in lots of 12	\$4.43 ea.
VLP 3 oz. in lots of 24	\$4.18 ea.

* Paasche bottles will fit most Iwata, Badger and Thayer & Chandler Airbrushes

the airbrush store
1-800-852-7874
www.airbrushstore.com

ACCESSORIES & STENCIL SUPPLIES

STENCIL MAKERS

By Hot Tools



- SM Stencil Burner 35.96
- SMN Stencil Burner Nib 6.30

STENCIL ADHESIVE

PLATINUM MIST SPRAY 2000

An adhesive designed specifically for use with textiles. Spray on back of stencil and let dry till tacky. Adhesive sticks to the stencil and does not transfer to the fabric.

- STAD Stencil Adhesive 6.08



7 PIECE CLEANING KIT

7 Piece Cleaning Kit is ideal for cleaning all makes/types of airbrushes.

AC-7 Airbrush Cleaning Kit

Retail: 19.50 **Our Price 15.60**



PELLON

• HEAVY WEIGHT •

A non-woven fabric used for painting display artwork and for practice. Also used for stencils. Easy to cut with burner or razor knife.

STANDARD (HEAVY) WEIGHT PELLON 14 x 14 (PEL14X14)

- 1 - 49 Sheets 70¢ ea
- 50 - 99 Sheets 66¢ ea
- 100+ Sheets 63¢ ea

STANDARD (HEAVY) WEIGHT PELLON 18 x 22 (PEL18X22)

- 1 - 49 Sheets 1.14 ea
- 50 - 99 Sheets 1.08 ea
- 100+ Sheets 1.03 ea

• STENCIL •

A heavy weight pellon that is also stiff. It is easily cut with a burner and absorbs paint. Ideal for making stencils.

STENCIL PELLON 15 x 18 (PEL15X18)

- 1 - 24 Sheets 1.18 ea
- 25 - 49 Sheets 1.12 ea
- 50+ Sheets 1.06 ea

STENCIL PELLON 18 x 20 (PEL18X20)

- 1 - 24 Sheets 1.28 ea
- 25 - 49 Sheets 1.22 ea
- 50+ Sheets 1.15 ea

PROFIT MAKING PRODUCTS



* AUTO TAG COVERS

Plastic Bubble Cover/Black Trim Frame. Protects airbrushed tags.

PLASTIC BUBBLE COVER ONLY (PBC)

- 1 - 23 2.45 ea
- 24 - 47 2.33 ea
- 48+ 2.21 ea

PLASTIC BUBBLE COVER AND FRAME (PBC/F)

- 1 - 11 3.35 ea
- 12 - 23 3.18 ea
- 24+ 3.02 ea



AUTO TAGS (AT)

6 x 12 .024 Aluminum Primed White Both Sides.

- 1 - 23 Tags 1.80 ea
- 24 - 49 Tags 1.71 ea
- 50 - 99 Tags 1.62 ea
- 100+ Tags 1.54 ea



KEY RINGS (KR)

Excellent profit making item! Cut 2" x 3" pieces of scrap pellon and paint custom names and designs. Then snap together.

- 1 - 23 Key Rings 1.20 ea
- 24 - 47 Key Rings 1.14 ea
- 48+ Key Rings 1.08 ea

*Special Order Items. Allow 10 - 14 days for delivery.

the airbrush store
1-800-852-7874
www.airbrushstore.com

\$56.95



THAYER & CHANDLER **Vega 2000**

This airbrush was designed with the T-shirt artist in mind. The Vega 2000 is engineered for easy maintenance, durability and precision artwork. All metal construction with chrome and nickel plated interior parts with an aluminum handle that provides balance without added weight. Designed for maximum performance, the Vega 2000 features a cut away handle that enables quick declogging of the tip. Smooth trigger action and almost twice the needle travel of other airbrushes enable the artist to achieve the finest lines and greatest finger tip control possible.

VEGA 2000 #3L Airbrush without Accessories:

List Price 88.00 **Our Price 56.95**

VEGA 2000 Set - Includes airbrush, #1, #3 and #5, Tip, Needle and Aircap, 6 ft. Airhose, 1/4 oz. Color Cup, 2 oz. and 1 oz. Bottle Assembly:

List Price 121.00 **Our Price 79.95**

VEGA PARTS

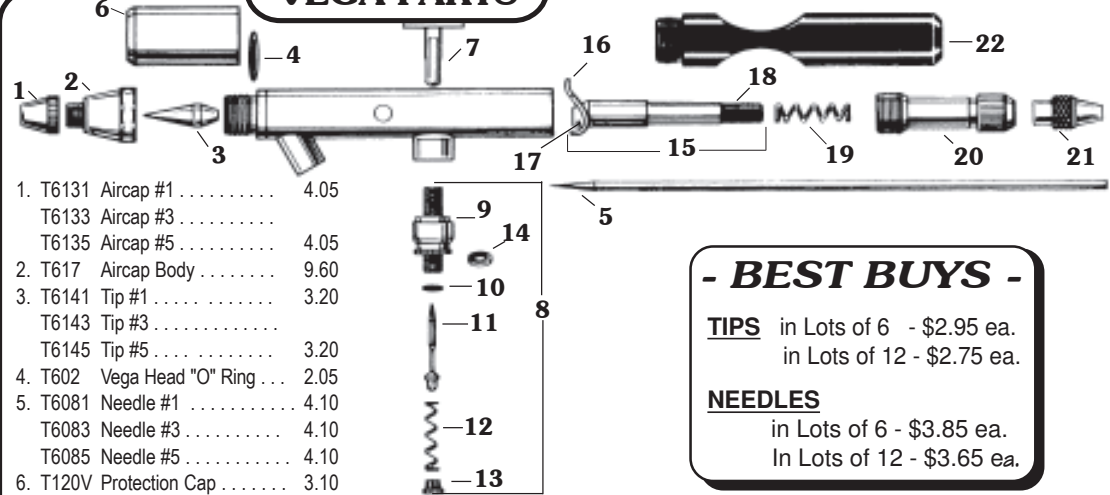

- 1. T6131 Aircap #1 4.05
- T6133 Aircap #3
- T6135 Aircap #5 4.05
- 2. T617 Aircap Body 9.60
- 3. T6141 Tip #1 3.20
- T6143 Tip #3
- T6145 Tip #5 3.20
- 4. T602 Vega Head "O" Ring . . . 2.05
- 5. T6081 Needle #1 4.10
- T6083 Needle #3 4.10
- T6085 Needle #5 4.10
- 6. T120V Protection Cap 3.10
- 7. T604 Finger Lever 3.15
- 8. T36 Air Valve Casing Asse . . 13.50
- 9. T13 Air Valve Casing 6.95
- 10. T141 Valve "O" Ring 2.05
- 11. T14 Valve Plunger 2.65
- 12. T20 Valve Spring 1.35
- 13. T90 Valve Nut 2.05

- 14. T603 Outside Valve "O" Ring . . 1.15
- 15. T610 Rocker Arm Assem. . . . 8.40
- 16. T606 Rocker 3.15
- 17. T607 Rocker Pin Arm 1.35
- 18. T609 Needle Support 5.75
- 19. T611 Spring 1.95

- BEST BUYS -

TIPS in Lots of 6 - \$2.95 ea.
in Lots of 12 - \$2.75 ea.

NEEDLES
in Lots of 6 - \$3.85 ea.
In Lots of 12 - \$3.65 ea.

- 20. T612 Needle Adj. Sleeve . . . 5.35
- 21. T616 Lock Nut 2.25
- 22. T670 Handle (Cut Away) . . . 7.45
- 23. 706 (Not Shown) 6' Air Hose. . . 10.75
- 24. 710 (Not Shown) 10' Air Hose. . . 14.00

the airbrush store
1-800-852-7874
www.airbrushstore.com



BY VEGA

\$69.50

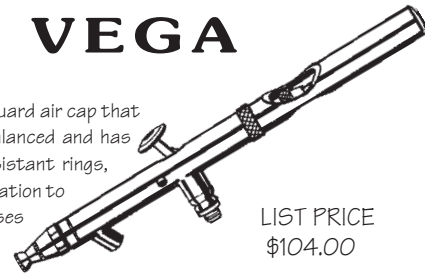

The Omni Detail Gun was designed to produce extreme detail. It offers a unique revers-a-guard air cap that enables the finest lines and also fine atomization for even coverage. The Omni is well balanced and has smooth trigger action. A durable chromed exterior, hard nickel interior, and solvent resistant rings, enable the Omni to withstand harsh solvents. It uses only one tip-needle combination to cover all spray ranges. All internal parts are compatible with the Vega and it uses the same bottles and jars. The Omni is a joy to use and compliments the Vega Airbrushes you may already own.



LIST PRICE
\$104.00

OMNI PARTS

1. 673	Omni Handle	9.25	5. 8141	Omni Tip	3.25
2. 8131G	Omni Aircap Guard	8.75	6. Q20AT	Quick Connect Adapter Plug	8.40
3. 8131	Omni Aircap	9.50	7. 802	"O" Ring Large	1.95
4. 8081	Omni Needle	4.70	8. 804	"O" Ring Small	2.15

FRISKETFILM
FOR AIRBRUSHING, MASKING AND STENCILING

Artool® FrisketFilm is a low tack, soft-peel, self-adhesive masking film which can be effectively used with most mediums.



Artool® FrisketFilm can be used in a variety of masking applications – from creating your own stencils to protecting your work from excessive handling.

- Available in matte and gloss finishes
 - Low-tack self-adhesive film
- Won't wrinkle, bleed or flutter under airbrush spray
- Can be removed and/or repositioned easily

In-Stock

Matte F 301 10" x 4 yds Roll
\$31.99

F 302 14" x 4 yds Roll
\$19.95

F 310 10 x 15" Sheets
(8 ea. per pack)
\$14.95

the airbrush store
1-800-852-7874
www.airbrushstore.com

the airbrush store



THE DELUXE KIT CONTAINS

- Airbrush
- Airhose
- Extra Tip & Needle
- 1 - 8 oz. Trans. Black
- 8 - 4oz. Colors (white, red, yellow, blue, bright orange, violet & hot pink)
- 1 - 4 oz. R-100
- 1 - 4 oz. T-100
- 12 VLP 3 oz. Bottles
- 1 Pack of Reddi Caps
- 10 Sheets of Pellon
- 6 Practice Tranfers



BASIC KIT

Everything you need to get started in Airbrushing except the Air Source!

THE BASIC KIT CONTAINS

- Airbrush
- Airhose
- Extra Tip & Needle
- 5 - 4oz. Colors (white, red, yellow, blue & black)
- 6 VLP 3 oz. Bottles
- 1 Pack of Reddi Caps
- 10 Sheets of Pellon
- 6 Practice Tranfers

Our Separate Prices – Kit Price

Paasche VL#3	154.99	131.74
Iwata Eclipse HP-BCS	261.94	222.65

AIR COMPRESSORS

1ST
Most airbrushes used for T-shirt painting use approximately 1 cubic ft. of air per minute. This is referred to as (CFM). If the compressor produces less than this it will always be working at maximum capacity to keep up with minimum air use of the airbrush. Industrial units are rated at 100 P.S.I. Pressure. The rating to look for is CFM Free Air at 100 P.S.I.

2ND
The compressor should have a piston pump with a cast iron cylinder. The air pump is the part of the compressor that actually compresses the air. Commercial artists need an air pump that's oil lubricated. Industry specifications note that oil lubed pumps have as much as twice the service life of oil-less units. NOTE: You do have to check the oil level and add oil occasionally. Oil-less units are ok for occasional, light duty use.

3RD
The motor is what turns the air pump, usually electric. Look for low ampreage use in relation to CFM output of the air compressor. It should also be equipped with an overload reset switch.

4TH
Last but not least, you must have an airtank to store the compressed air. This provides an even flow of air without the sputtering of tankless units. A regulator with a moisture trap completes the air source. Now plug in your airbrush and start painting.

Call us. Due to the many types of air compressors, we don't carry them in inventory - however, we can special order whatever you need and have it to you within 7-10 days.

the airbrush store
1-800-852-7874
www.airbrushstore.com

iwata

\$107.⁰¹

ECL 2000

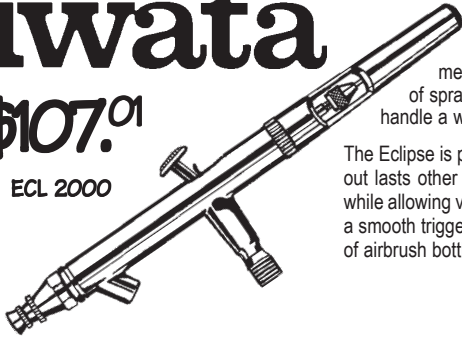

The Iwata Eclipse is a dual action, internal mix, bottle feed airbrush. It is designed for artists requiring reliability and performance. T-shirt painters, fine artists, sign and automotive painters all find that the Eclipse meets their needs. This is a very versatile airbrush, capable of spraying fine hair lines and broad, even coverage. It can also handle a wide variety of paints from heavy enamels to water-based acrylics and fine lacquers.

The Eclipse is precision made from the finest materials. The tip is made from steel - not brass - and far out lasts other brands' airbrush tips. Iwata also designed an aircap that protects the tip and needle while allowing very close precision work and is still easy to clean. The airbrush is well balanced and has a smooth trigger control that ensures consistent performance. The Eclipse accepts most major brands of airbrush bottles and jars so you can use the ones you may already have.

Eclipse

ECL 2000 - HP-BCS List Price 129.73 **OUR PRICE 107.01**

ECL 2006M - HP-BCS Six Pack LIST PRICE 726.10 **OUR PRICE 598.68**

ECL 2001 - HP-BCS Set List Price 145.18 **OUR PRICE 120.44**
 HP-BCS Set includes airbrush, 10ft. hose, 3 oz plastic bottle, sample airbrush cleaner & paint.

ECLIPSE PARTS

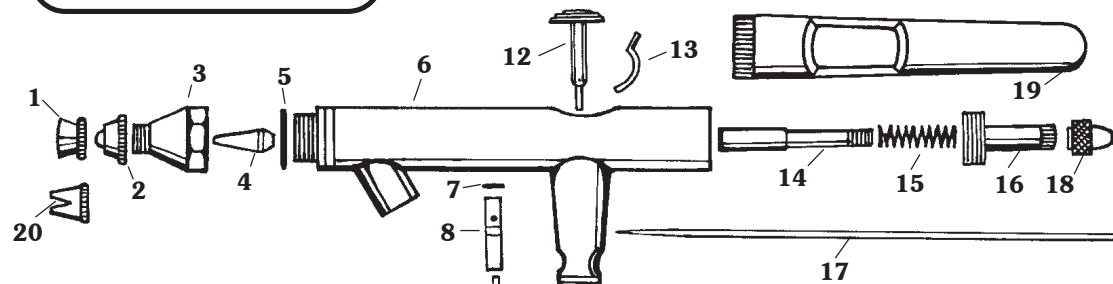

1. I 601 1	Aircap (needle cap)	5.33	13. I 040 5	Auxillary lever (rocker)	5.33
2. I 602 1	Nozzle cap	8.82	14. I 115 2	Needle chucking guide	11.60
3. I 603 1	Headcap body	11.60	15. I 135 2	Needle spring	5.33
4. I 604 1	Tip (nozzle)	11.60	16. I 170 2	Spring guide (adjusting sleeve)	11.60
5. I 605 1	Packing Head O-Ring	5.33	17. I 617 1	Needle	8.82
6. I 606 1	Airbrush Body (Special Order)	97.43	18. I 120 2	Needle lock nut	5.33
7. I 580 1	Packing-Valve Piston O-Ring	8.82	19. I 619 1	Handle (cut away)	23.22
8. I 608 1	Airvalve guide body	8.82	20. I 105 0	Crown cap	17.63
9. I 609 1	Airvalve plunger	5.33	21. BT-010 10' Airhose (not shown)		19.00
10. I 510 4	Airvalve spring	8.82	22. CT-1-10 10' Cobra coil hot airhose (not shown)		20.40
11. I 611 1	Airvalve guide screw	5.33			
12. I 612 1	Finger lever	11.60			

COMMON AIRBRUSH TERMS

internal mix—a type of airbrush where the paint is atomized inside the airbrush tip. (All IWATA airbrushes are internal mix, including the new Eclipse.)
external mix—a type of airbrush where the paint is atomized outside the airbrush tip (SprayCraft Airbrush).
single action—a method of activating an airbrush whereby depressing the trigger delivers both air and paint simultaneously (SprayCraft Airbrush).
dual action—a method of activating an airbrush whereby depressing the trigger delivers air and drawing back on the trigger releases paint. (All IWATA airbrushes are dual-action, excluding the new Eclipse SA.)
bottom feed—a siphon-feed system where paint is drawn up from a reservoir (jar or color cup) mounted underneath the airbrush (IWATA HP-BC and BE, Eclipse, and LPH95).
side feed—a siphon-feed system where paint is drawn from a reservoir (color cup) mounted on the side of the airbrush (IWATA-HP-SB and Custom Micron SC).
gravity feed—the system where paint is drawn into an airbrush from a reservoir mounted on top of the airbrush (IWATA HP-C, HP-A, B and C, Custom Micron B and C, RG-2, LPH94 and LPS2-1).

the airbrush store
 1-800-852-7874
 www.airbrushstore.com

\$49.¹⁴

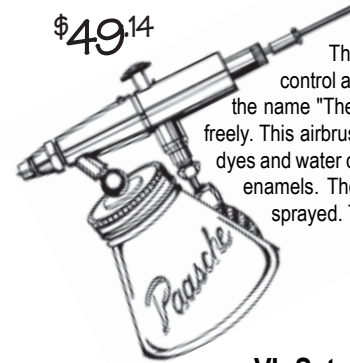

Paasche VL Airbrush

This is the most popular and dependable airbrush used by T-shirt artists today. It features double action control and interchangeable multiple head assemblies. The VL can withstand continuous use and has earned the name "The Workhorse" of the industry. The VL has a self centering tip that is designed to allow fluids to flow freely. This airbrush is capable of fine lines and broad coverage. The VL-1 is best suited for light fluids such as inks, dyes and water colors. The VL-3 is suited for thinned acrylics, enamels and lacquers. The VL-5 is for heavy fluids like enamels. The recommended air pressure is from 20 to 60 psi depending on tip size and type of fluid being sprayed. The VL requires 1 cubic foot of air per minute.

VL#3L Airbrush List Price 86.00 **OUR PRICE 49.14**

VL#3L Six Pack List Price 454.00 **OUR PRICE 259.43**

VL Set includes the airbrush #1, #3, #5 Tips & Needles, 3 oz. Bottle Assembly, 1 oz. Bottle Assembly, 6ft. Air Hose, Hanger, Wrench, Color Cup, Lesson Booklet & Parts Diagram:

List Price \$124.00 **OUR Price 70.86**

VL - PARTS

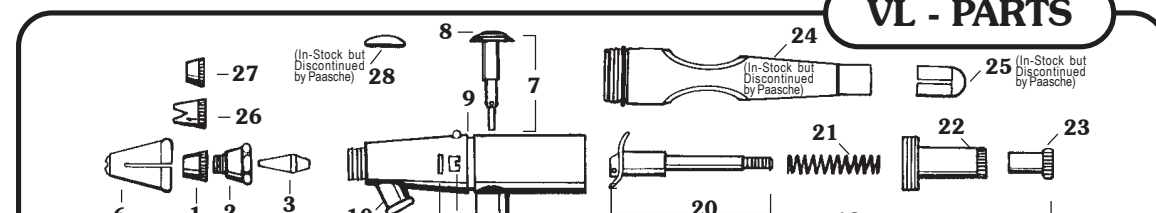

1. VLA-1	Aircap	4.84	15. A-52	Valve Washer (6 Pack)	3.96
VLA-5	Aircap	4.84	16. H-21A	Valve Plunger	1.64
VLA-3	Aircap	4.84	17. A-22	Valve Spring	1.40
2. VLB	Aircap Body	6.20	18. A-23A	Air Valve Nut	1.84
3. VLT-1	Tip	4.99	19. VL-186	Needle Valve Assem	9.20
VLT-3	Tip	4.99	20. VL-191A	Rocker Arm Assem	6.92
VLT-5	Tip	4.99	21. VL-140	Spring	1.68
4. VLN-1	Needle	4.99	22. VL-136A	Needle Adj. Sleeve	3.92
4a. VLN-3	Needle	4.99	23. VL-141	Locknut	2.92
VLN-5	Needle	4.99	24. VL-134C	Handle w/ Cut Out (Discontinued)	4.86
4b. VLN-1P	Polished Needle	5.99	25. VL-118	Protecting Cap (Discontinued)	1.35
5. VL-54	Reamer	6.16	26. Crown-1	Air Cap	4.76
6. VL-189	Head Protecting Cap	2.80	27. PP	Paint Picker Air Cap	4.76
7. VL-174	Finger Lever Assembly	6.99	28. VL-216	Pro Finger Button (Discontinued)	2.20
8. VL-135A	Finger Button	1.80			
9. VL-175	Line Adj. Assembly	5.28			
10. VL-163	VL Shell	28.80			
11. MU-61	Packing Washer	2.20			
12. MU-62	Packing Nut	2.20			
13. VL-176	Air Valve Assembly	7.28			
14. VL-20	Valve Casing	4.88			

- BEST BUYS -

VL TIPS
 Lots of 6 - \$4.74 ea.
 Lots of 12 - \$4.49 ea.

VL NEEDLES
 Lots of 6 - \$4.74 ea.
 Lots of 12 - \$4.49 ea.

PRICE MATCHING

Although we price our items aggressively, you may, on occasion, find a lower price somewhere else. If you prefer to order from us - give us a call - we'll try to match the lower price - or beat it - if we can. Our only requirement is that our competitor must have the item in stock, ready to ship.

the airbrush store
 1-800-852-7874
 www.airbrushstore.com